

Concordia Neighborhood



www.historicmilwaukee.org
 facebook.com/historicmilwaukee
 @HistoricMKE



A. George Koch "Lion House"
 Built: 1897
 Designation: Local (Part of National Highland Blvd Dist.)



B. Concordia District
 Built: 1850 - 1930
 Designation: Nat'l & Local

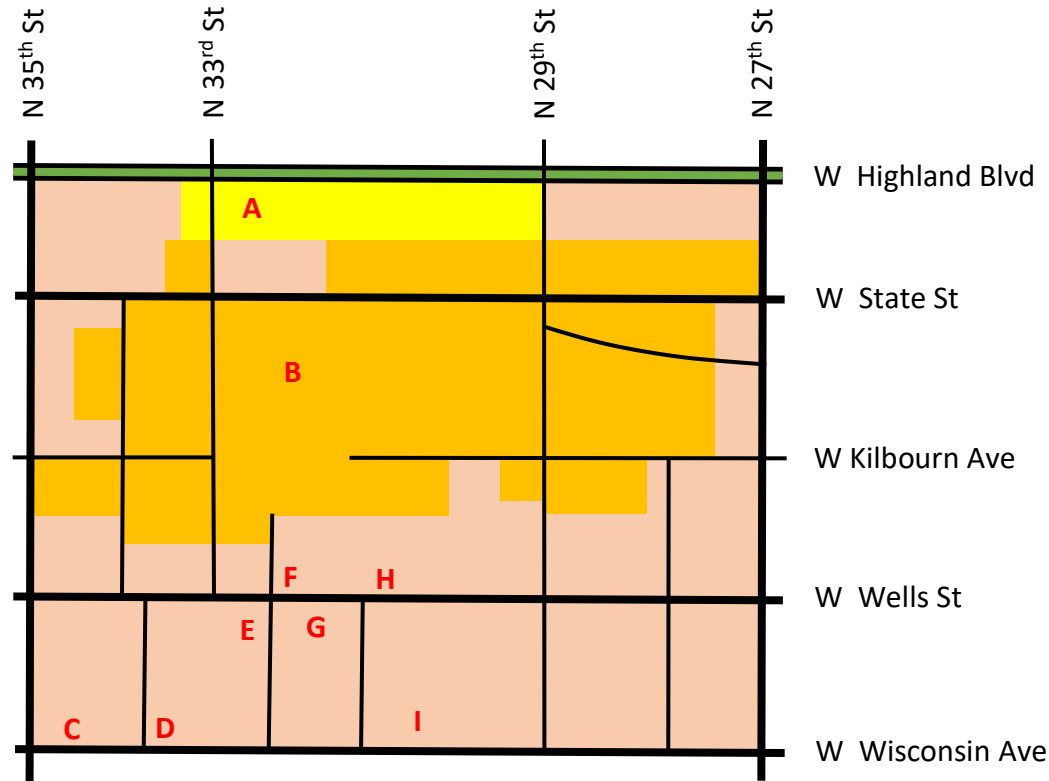

Images from Google Street View and Wikipedia



I. Tripoli Temple
 Built: 1926
 Designation: National



H. David W Howie House
 Built: 1886
 Designation: National



C. Henry Harnischfeger House
 Built: 1905
 Designation: Local



D. Edward J. Dahinden House
 Built: 1914
 Designation: National



E. George Schuster House
 Built: 1891
 Designation: Nat'l & Local



F. Harry B. Walker House
 Built: 1878
 Designation: National

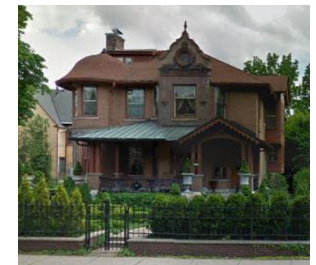

G. Abraham H. Esbenshade house
 Built: 1899
 Designation: National